

QUICK START GUIDE

1

Please Read Owner's Manual

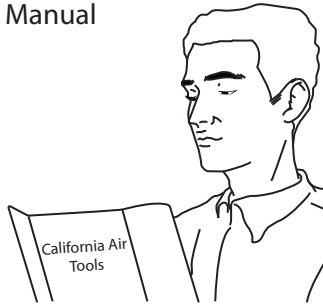

2

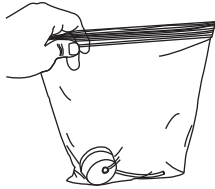

Air Filter Tube Installation

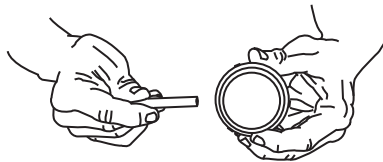

3

Air Filter Installation

Screw Air Filter (s) into the port (s) located on the motor head.

Hand tighten only

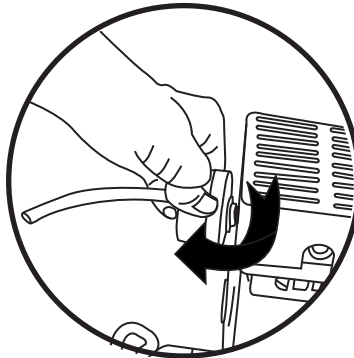

4

¼" Industrial
"Push to Connect"
Quick Connector

Push
to Connect



Drain Valve Operation

5

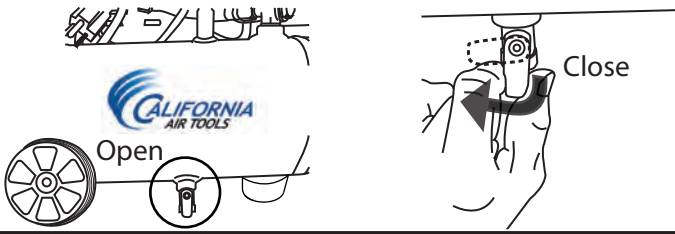

6

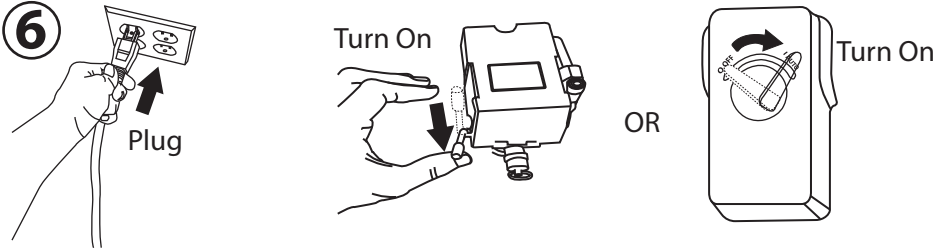

7

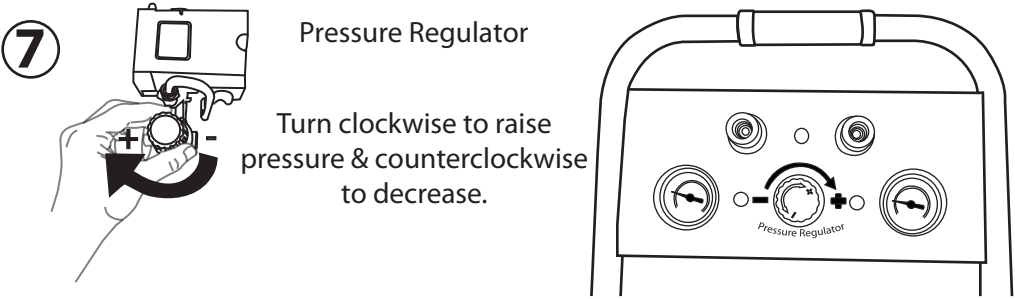

8

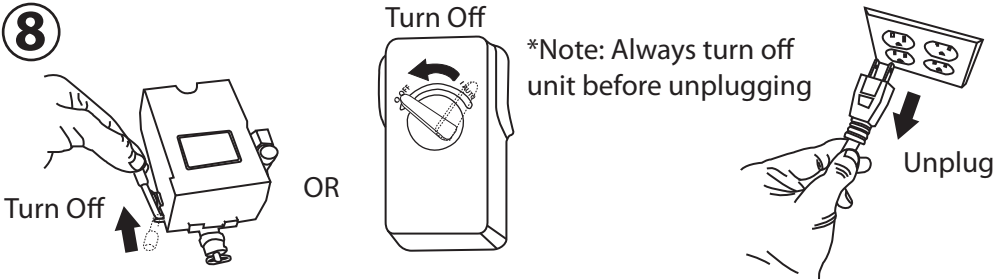

9

